

OPERATION MAUNAL & PARTS LIST

UNIVERSAL MOBILE BASE

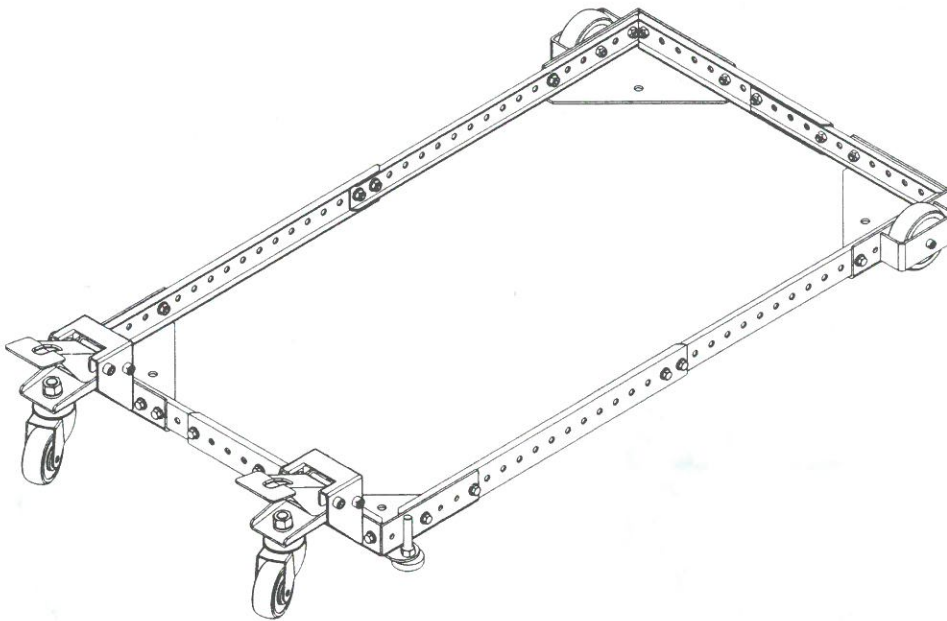

Specification:

Capacity 500 lbs(230kg)

Minimum Square Sizes 11"x 11" (279 x 279 mm)

Maximum Square Sizes 35-1/4"x 35-1/4" (894 x 894 mm)

Minimum Rectangular Sizes: 17"x 11" (434 x 279 mm)

Maximum Rectangular Sizes: 51"x 19" (1295 x 483 mm)

READ THIS MANUAL CAREFULLY BEFORE ASSEMBLY, TESTING & QPERATION
--

Unpacking & Checking Contents:

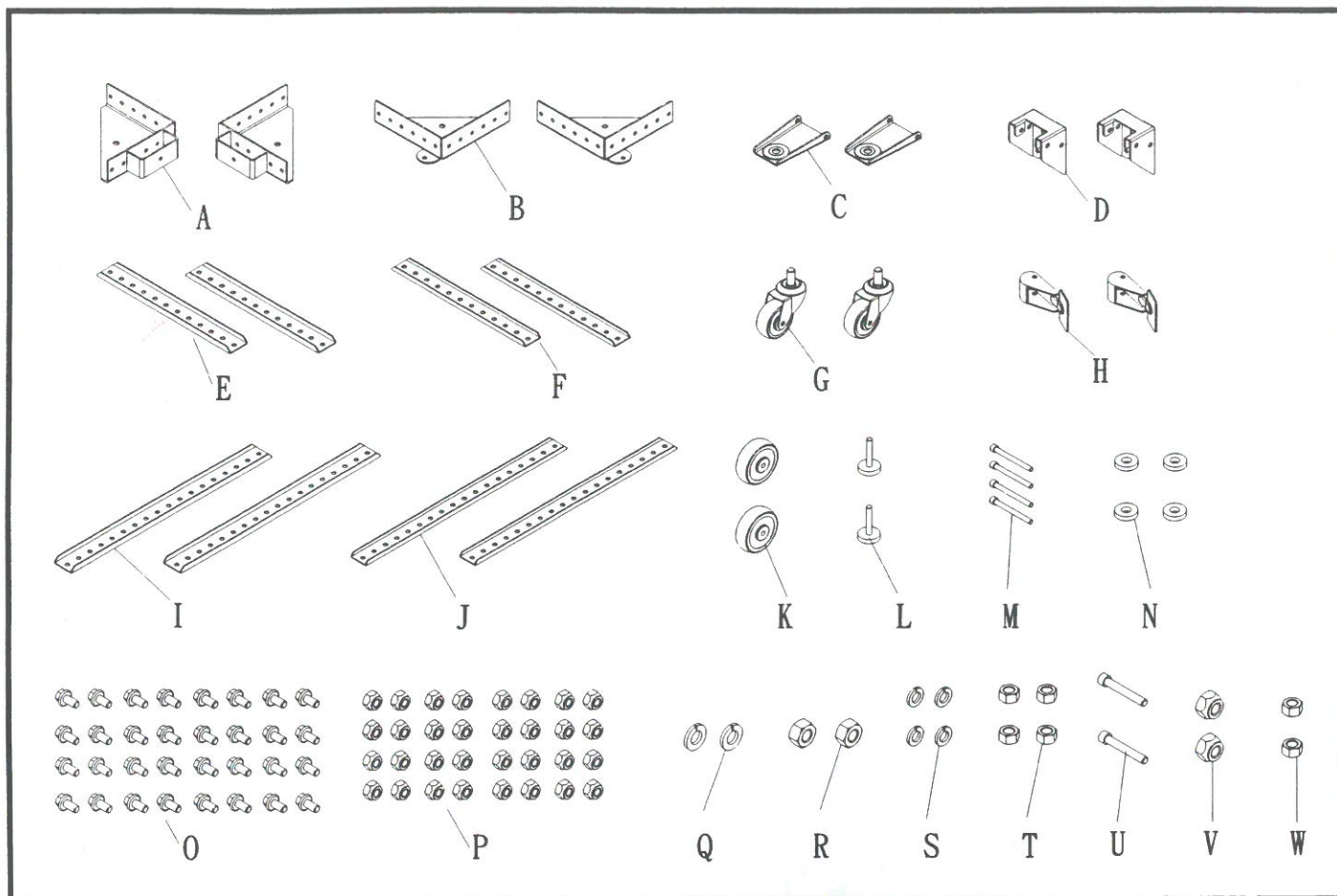

A: Fixing Wheel Bracket (left, right) Rear
 B: Movable Wheel Front Bracket (left, right)
 C: Movable Plate
 D: Wheel Bracket
 E: Exterior Short Plate
 F: Interior Short Plate
 G: Movable Wheel
 H: Pedal
 I: Exterior Long Plate
 J: Interior Long Plate
 K: Fixing Wheel
 L: Foot Pad

M: Cap. Screw 5/16" * 3-1/2"
 N: Anti-Shaking Pad
 O: Hex. Screw 1/4" * 1/2"
 P: Nut 1/4"
 Q: Spring Washer 1/2"
 R: Nut 1/2"
 S: Spring Washer 5/16"
 T: Nut 5/16"
 U: Cap. Screw 1/4" * 1-3/4"
 V: Lock Nut 1/4"
 W: Nut 3/8"

Step 1.

Take the wheel bracket (D), movable plate (C), pedal(H), movable wheel(G), anti-shacking pad (N), spring washer 1/2" (Q), nut 1/2" (R), nut 5/16"(T), spring washer 5/16" (S), cap screw 5/16"*3-1/2" (M), tight together. (see Fig. 1) Please see (Fig. 2)
To see the complete wheel set.

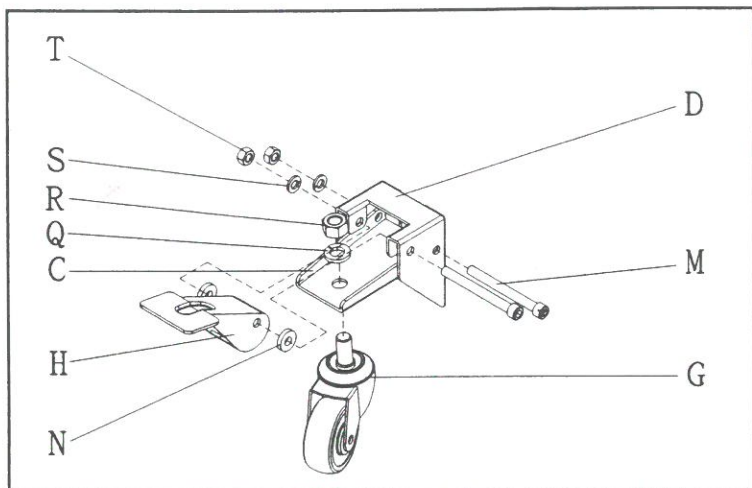

(FIG. 1)

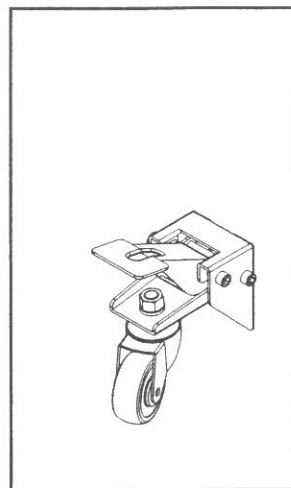

(FIG. 2)

STEP 2.

Take the fixing wheel bracket(A), cap screw 1/4"*1-3/4"(U), fixing wheel(K), Nut 1/4"(P), assemble together. (See Fig. 3)

STEP 3.

Take the movable wheel front bracket(B) assemble with the wheel set (Fig 2.) Together. Also tight the foot pad(L) on the bracket (B) with 3/8" nut (W). (See Fig. 3)

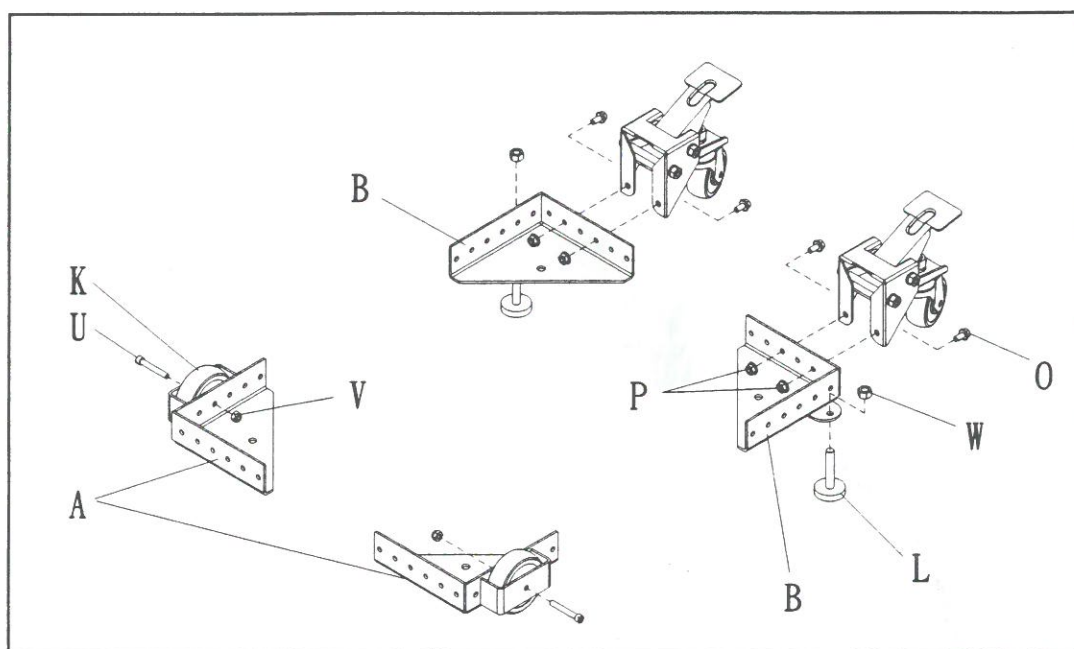

(FIG. 3)

STEP 4.

Measure the length of the machinery then tight the exterior long plate (I), interior long plate (J), with hex. screw $1/4" \times 1/2"$ (O), nut $1/4"$ (P) together on the complete set in step 3. (See Fig. 4)

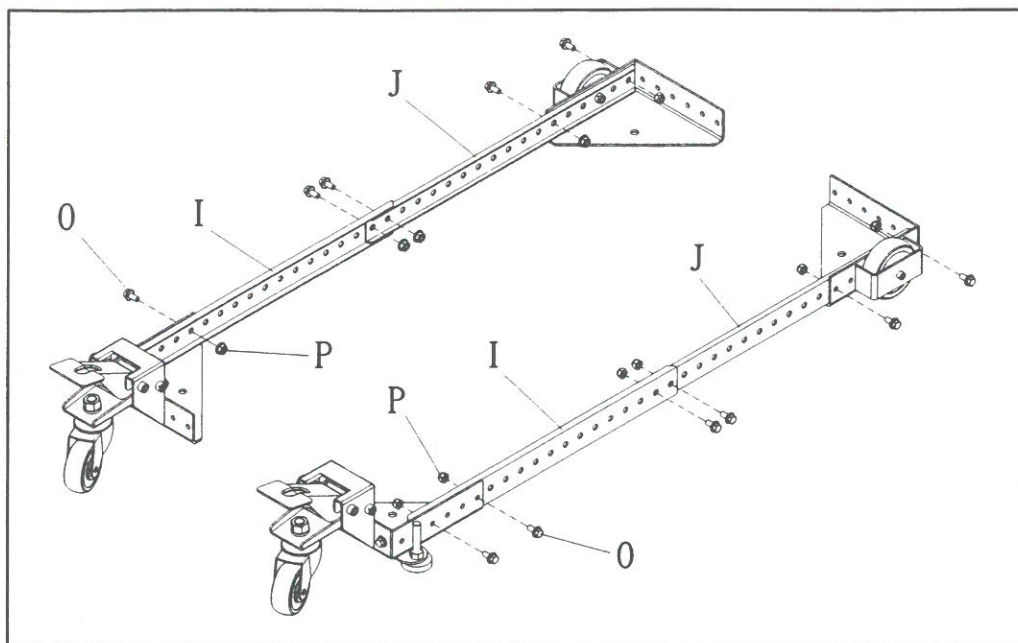

(FIG. 4)

STEP 5.

Take the exterior short plate (E), interior short plate (F), hex. screw $1/4" \times 1/2"$ (O), nut $1/4"$ (P) assemble together. (See Fig. 5) Then adjust the width as you need for the machinery. Assembly steps are all completed.

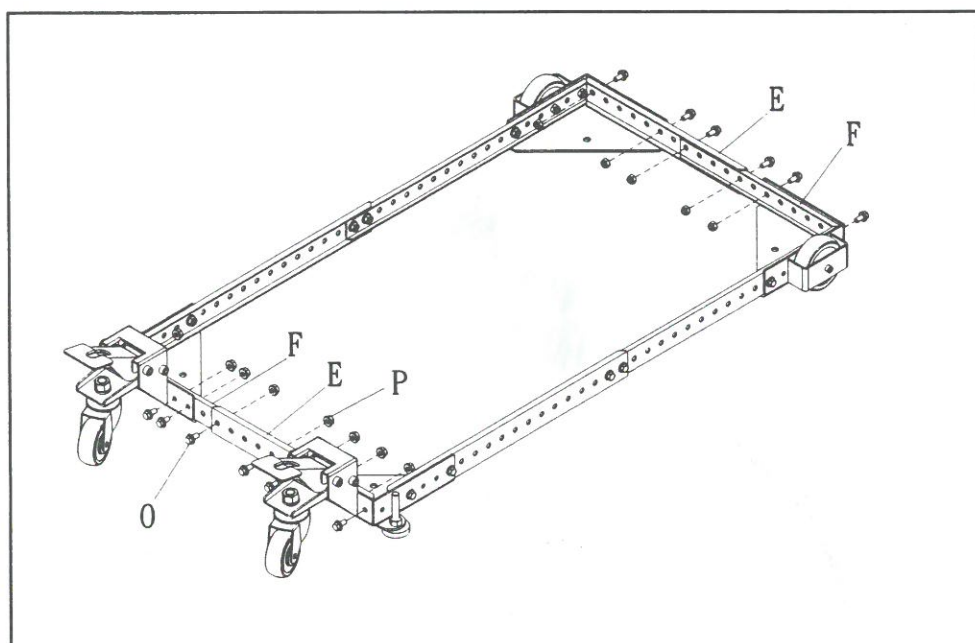

(FIG. 5)

EXPLODE DIAGRAM

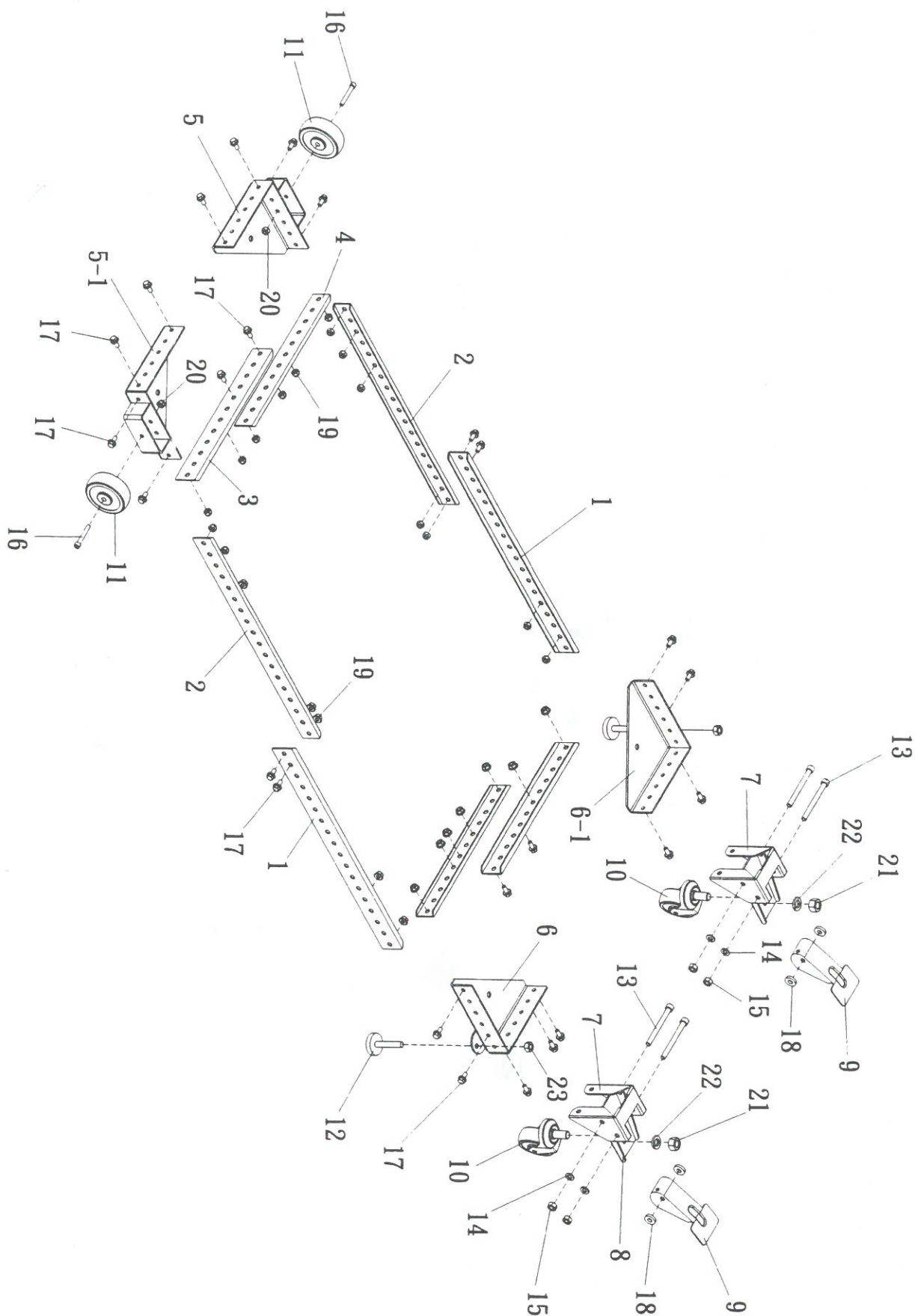

PART LIST

NO.	DESCRIPTION	SPECIFICATION	Q, TY
1	Exterior Long Plate	17-1/2"*1-1/2"	2
2	Interior Long Plate	17-3/4"*1-3/8"	2
3	Exterior Long Plate	11-1/2"*1-1/2"	2
4	Interior Long Plate	11-3/4"*1-3/8"	2
5	Fixing Wheel Bracket (left) Rear		1
5-1	Fixing Wheel Bracket (right) Rear		1
6	Movable Wheel Front Bracket(left)		1
6-1	Movable Wheel Front Bracket(right)		1
7	Wheel Bracket		2
8	Movable Plate		2
9	Pedal		2
10	Movble Wheel	1/2"*2-1/2"	2
11	Fixing Wheel	5/16"*3"	2
12	Foot Pad	3/8"*2"	2
13	Cap. Screw	5/16"*3-1/2"	4
14	Spring Washer	5/16"	4
15	Nut	5/16"	4
16	Cap. Screw	1/4"*1-3/4"	2
17	Hex. Scr	1/4"*1/2"	32
18	Anti-Shaking Pad	08. 5*018*3. 8T	4
19	Nut	1/4"	32
20	Lock Nut	1/4"	2
21	Nut	1/2"	2
22	Spring Washer	1/2"	2
23	Nut	3/8"	2